

# Inductive slot sensor SJ3,5-N-K37

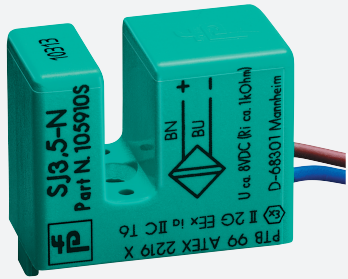

■ Comfort series



## Dimensions

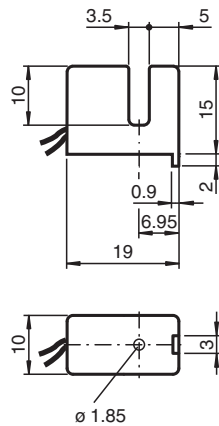

## Technical Data

### General specifications

Switching function	Normally closed (NC)
Output type	NAMUR
Slot width	3.5 mm
Depth of immersion (lateral)	5 ... 7 typ. 6 mm
Output type	2-wire

### Nominal ratings

Nominal voltage	$U_o$	8.2 V ( $R_i$ approx. 1 k $\Omega$ )
Operating voltage	$U_B$	5 ... 25 V
Switching frequency	$f$	0 ... 3000 Hz
Hysteresis	$H$	0.41 ... 0.6 mm

### Current consumption

Measuring plate not detected	$\geq 3$ mA at nominal voltage
Measuring plate detected	$\leq 1$ mA at nominal voltage

### Functional safety related parameters

MTTF <sub>d</sub>	5270 a
Mission Time ( $T_M$ )	20 a

Release date: 2023-01-27 Date of issue: 2023-01-27 Filename: 70132990\_eng.pdf

Refer to "General Notes Relating to Pepperl+Fuchs Product Information".

Pepperl+Fuchs Group  
www.pepperl-fuchs.com

USA: +1 330 486 0001  
fa-info@us.pepperl-fuchs.com

Germany: +49 621 776 1111  
fa-info@de.pepperl-fuchs.com

Singapore: +65 6779 9091  
fa-info@sg.pepperl-fuchs.com

 PEPPERL+FUCHS

## Technical Data

Diagnostic Coverage (DC)	0 %	
<b>Compliance with standards and directives</b>		
Standard conformity		
NAMUR		EN 60947-5-6:2000 IEC 60947-5-6:1999
Standards		EN 60947-5-2:2007 EN 60947-5-2/A1:2012 IEC 60947-5-2:2007 IEC 60947-5-2 AMD 1:2012
<b>Approvals and certificates</b>		
IECEX approval		
Equipment protection level Gb		IECEX PTB 11.0091X
Equipment protection level Da		IECEX PTB 11.0091X
Equipment protection level Mb		IECEX PTB 11.0091X
ATEX approval		
Equipment protection level Gb		PTB 99 ATEX 2219 X
Equipment protection level Da		PTB 99 ATEX 2219 X
UL approval		cULus Listed, General Purpose
<b>Ambient conditions</b>		
Ambient temperature		-25 ... 100 °C (-13 ... 212 °F)
<b>Mechanical specifications</b>		
Connection type		flexible leads LiY
Housing material		PBT
Degree of protection		IP67
Cable		
Cable diameter		1.1 mm ± 0.1 mm
Bending radius		> 10 x cable diameter
Material		PVC
Core cross section		0.14 mm <sup>2</sup>
Length	L	500 mm
<b>General information</b>		
Use in the hazardous area		see instruction manuals

## Connection

